



OAKFIELD



Heath Square, Haywards Heath RH16 1AT

£1,175 Per Calendar Month

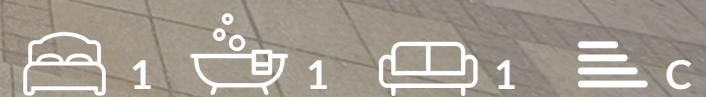

Heath Square, Haywards Heath RH16 1AT

Located in the popular Boltro Road area of Haywards Heath is Heath Square where this one bedroom first floor apartment is situated.

When entering the property you are welcomed into the open plan living space offering a modern kitchen with electric oven and induction hob as well as an integrated washing machine. The apartment offers a spacious double bedroom. The bathroom is a modern suite with a bath and handheld shower attachment.

The property is ideally situated less than half a mile from Haywards Heath Railway Station and offers an allocated parking space as well as gas central heating.

Please note:

An annual household income of £35,250 will be required for the affordability criteria of this property.

The minimum tenancy length is 12 Months.

Available from end of November 2025.





Lounge/Kitchen
18'1 x 16'0 (5.51m x 4.88m)

Bedroom
11'8 x 11'7 (3.56m x 3.53m)

Bathroom
7'3 x 6'0 (2.21m x 1.83m)

Council Tax Band B - £1,817.36 Per annum



Floor Plan

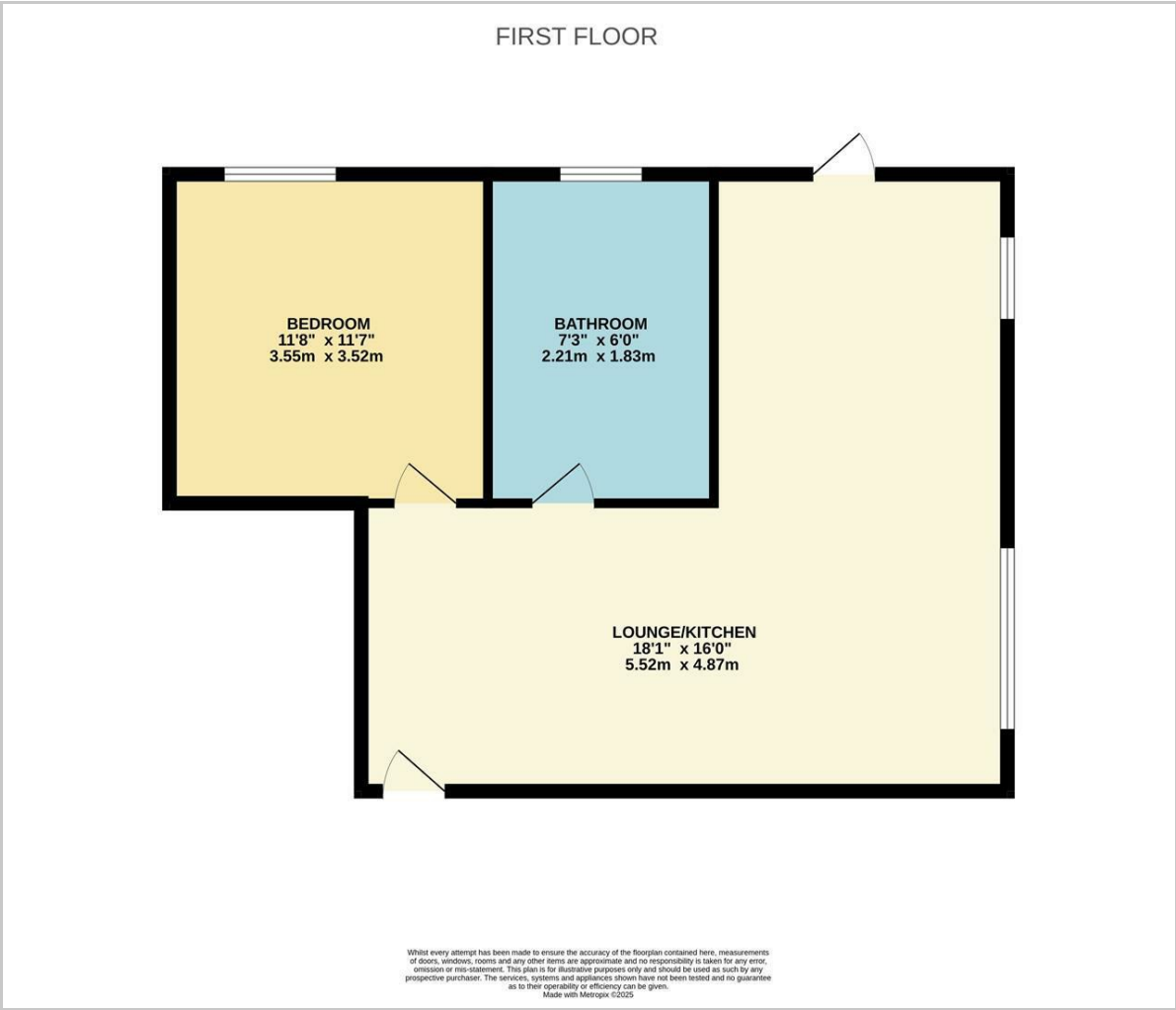

Viewing

Please contact us on 01825 729673 if you wish to arrange a viewing appointment for this property or require further information.

These particulars, whilst believed to be accurate are set out as a general outline only for guidance and do not constitute any part of an offer or contract. Intending purchasers should not rely on them as statements of representation of fact, but must satisfy themselves by inspection or otherwise as to their accuracy. No person in this firms employment has the authority to make or give any representation or warranty in respect of the property.

Area Map



Energy Efficiency Graph

